

VCL-412H



Features

- 1/3" Super HAD CCD II (SONY)
- High Sensitivity **600TV LINE**
- Min. Illumination 0.2Lux
- 2D-DNR , HLC , OSD, D-WDR
- Privacy Zones , 4 Motion Detection
- **Various Lenses Selectable**
- **Waterproof(IP67): VCL-F412H-WX only**

Dimension

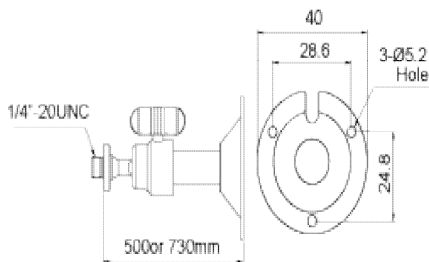
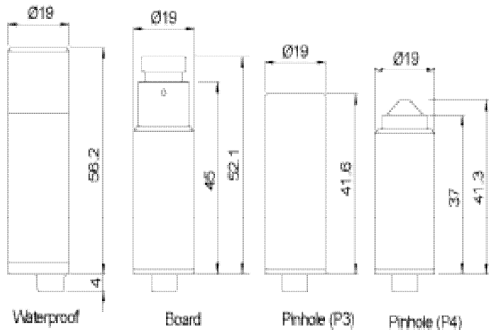

Option



OSD Cable

Specification

| Signal System | NTSC | PAL | |
|-------------------------|--|---|--|
| Total Pixels Number | 811(H) x 508(V) 410K | 795(H) x 596(V) 470K | |
| Effective Pixels Number | 768(H) x 494(V) 380K | 752(H) x 582 (V) 440K | |
| Pick-up Device | 1/3 inch Interline Super HAD CCD II (SONY) | | |
| Lens Fitted | Board, Pinhole | | |
| Signal Process | Digital Signal Process | | |
| Scanning System | 2:1 Interlace | | |
| Sync. System | Internal | | |
| Scanning Frequency | 59.94Hz(VD) | 50Hz(VD) | |
| Resolution | 600 TV lines | | |
| S/N Ratio | More than 48dB (AGC Off) | | |
| Video Output | 1.0 Vpp composite(75 Ω) | | |
| Min. Illumination | 0.2Lux @ F2.0 | | |
| OSD | CAMERA TITLE | OFF/ ON(0~9,A~Z, Special Character) | |
| | LENS | DC/ VIDEO/ MANUAL | |
| | EXPOSURE | SHUTTER/ BRIGHTNESS/ AGC/ DWDR | |
| | WHITE BALANCE | ATW1/ ATW2/ AWC-SET/ MANUAL | |
| | DAY & NIGHT | AUTO/ COLOR/ BW(IR SMART)/ EXT | |
| | BACK LIGHT | OFF/ BLC/ HLC | |
| | SPECIAL | PARK LINE/ MOTION(4 AREAS)/ PRIVACY(8 AREAS) | |
| | | DPC(Dead Pixel Compensation)/ COM ADJ(Communication Adjust) | |
| IMAGE ADJUST | LENS SHADING/ 2DNR/ MIRROR/ FONT COLOR | | |
| | ID&TITLE/ CONTRAST/ SHARPNESS/ DISPLAY/ NEG. IMAGE | | |
| LANGUAGE | ENGLISH/ CHINESE | | |
| Shutter Speed | 1/60 ~ 1/100,000sec | 1/50 ~ 1/100,000sec | |
| Power Consumption | DC12V, Max. 80mA | | |
| Operating Temperature | -10 $^{\circ}$ C ~ 50 $^{\circ}$ C (Humidity : 0%RH ~ 80%RH) | | |
| Storage Temperature | -20 $^{\circ}$ C ~ 60 $^{\circ}$ C (Humidity : 0%RH ~ 85%RH) | | |
| Options | Lens, Cable OSD function, | | |

VCL-412H

Interface

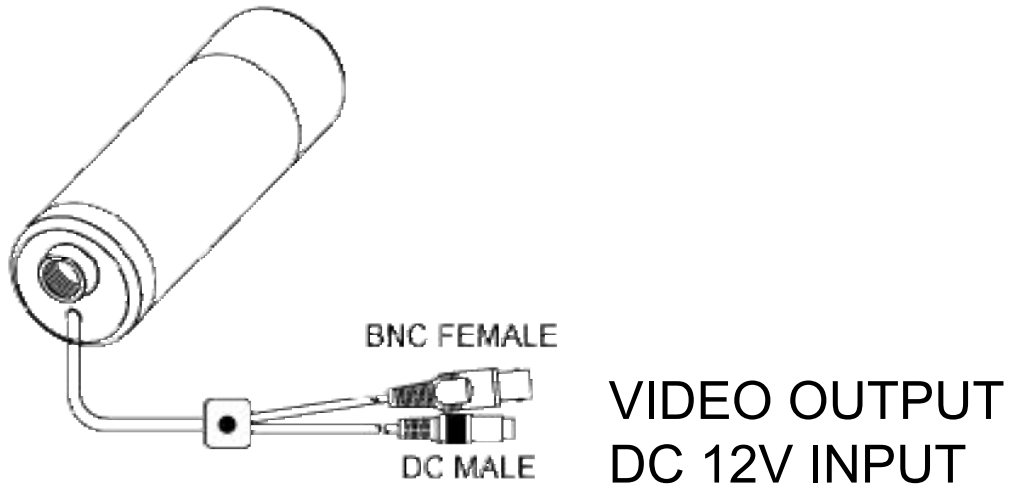

Standard Connection

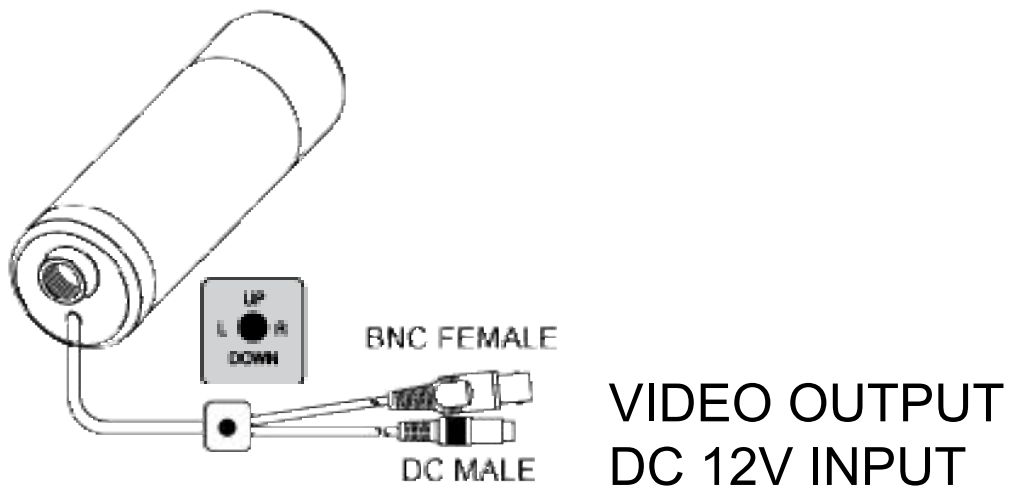

Cable OSD Connection