

VCL-F4D2H



Features

- ◆ 1/3 type Panasonic **CMOS**
- ◆ f=3.6mm Fixed Lens
- ◆ **AHD 2.0 (1080P@30fps)**
- ◆ CVBS(High Resolution of 850 TVL
- ◆ Slow Shutter control (Sens-Up)
- ◆ **Enhanced 2D/3D-NR**
- ◆ DEFOG / HLC / BLC / D-WDR
- ◆ FRC (Frame Rate Control)
- ◆ **UTC(Coaxial Cable(Pelco-C))**

Specification

| | | |
|---------------------|------------------------|---|
| Camera | Image Device | 1/3 type Panasonic CMOS |
| | Scanning System | Progressive Scan |
| | Total Pixels | 1956(H) x1266(V) : 2.48Mega pixels |
| | Effective Pixels | 1944(H) x 1092(V) : 2.12Mega pixels |
| | Lens | Board |
| | Min. Illumination | 0.1Lux@F2.0 , 30IRE |
| | Sync System | Internal |
| | Electronic Shutter | NTSC : 1/30~1/50,000sec(X2~X30), PAL : 1/25~1/50,000sec (X2~X30) |
| Video | Output | AHD (NTSC, PAL) or CVBS(960H, NTSC, PAL) |
| | Resolution& frame rate | 1080@30p/25p |
| OSD | Language | English, Korean, Japanese, Chinese, Russian, French, Spanish, Italian, Portuguese, Dutch, German, Polish, Turkish, Hebrew, Arabic |
| | LENS | DC/ MANUAL |
| | EXPOSURE | SHUTTER/ AGC/ SENS-UP(max. x30)/ BRIGHTNESS/ D-WDR/ DEFOG |
| | BACK LIGHT | OFF/ BLC/ HSBLC |
| | WHITE BALANCE | AWB/ATW/ PUSH LOCK/ INDOOR/ OUTDOOR/ MANUAL |
| | DAY&NIGHT | AUTO/ COLOR/ B&W/ EXTERN |
| | 2/ 3DNR | OFF/ LOW/ MIDDLE/ HIGH |
| | SPECIAL | CAM TITLE/ D-EFFECT/ MOTION/ PRIVACY/ LANGUAGE DEFECT/ RS485 |
| | ADJUST | SHARPNESS/ MONITOR/ LSC/ VIDEO.OUT |
| | Others | Operating Temperature |
| Storage Temperature | | -4°F~140°F (-20°C~+60°C) |
| Humidity | | Less than 80% |
| Power Consumption | | DC12V(±10%), Max.100mA |

Dimension

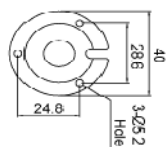
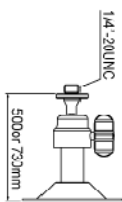
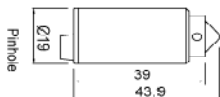
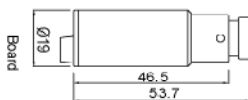
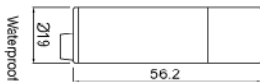

Option



Lens

VCL-F4D2H

Interface

